

Double-sided "FT"
keys only

9/02300
compression lock,
with straight latch bar,
shown in fully-extended
'open' position

ORDERING CODE

9/02300	Compression lock, chrome
9/02300/01	as above, FT111
9/02300B	Compression lock, black
9/02300B/01	as above, FT111

SPECIFICATION



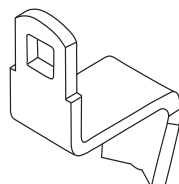
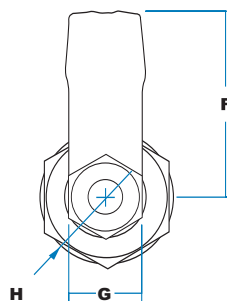
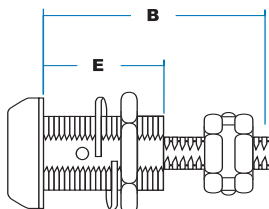
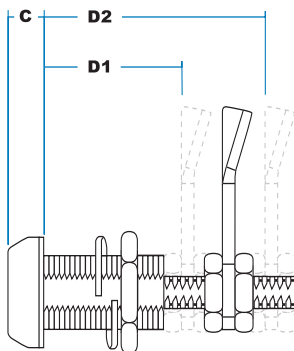





A	Head Diameter	29 mm
B	Total Depth (locked)	70 mm
C	Head projection	8 mm
D1	Depth to latch (min)	44 mm
D2	Depth to latch (max)	55 mm
E	Body depth	40 mm
F	Engagement	47.6 mm
G	Body across flats (square)	18.8 mm
H	Body diameter	22 mm
I	"Take-up" Depth	6 mm



Alternative latch bars
allow dimension D1 to
be reduced to 14mm -
See Page A14 for
options available.

KEY-OPERATED COMPRESSION LOCKS

A new lock design, intended for use with gasketed doors, which provides 6mm of compression to make a firm seal. It is water-resistant, fully adjustable, and is mounted within an industry-standard 4-sided panel aperture. Straight latch as standard, with a full range of other bars available.

-  Very positive engagement, water-resistant and adjustable.
-  Key brings latch bar into 'closed' position, then draws-up bar by 6mm against seal.
-  Key turns clockwise through 90 degrees to operate latch, then through a further quarter-turn to compress against door-edge or striker. Latch bar is adjustable through 11mm.
-  Fix through industry-standard 4-sided aperture with brass nut & stainless spring-washer on threaded body, and neoprene gasket. Latch-bar secured by nut and locknut on threaded spigot.
-  'FT' keys with shuttered keyway as standard.
-  Chromium-plated as standard, optionally black powder-coated.
-  Alternative latch bars. Special key numbers
-  WBH design covered by UK Patent Application 0224237.8
-  Highly cost-effective against market alternatives.