



Double-sided
'FT' Keys are
standard



9/01861

ORDERING CODE

9/01861 Turnbutton, chrome, 90° LH

9/01861/01 As above, FT111 keys

Panel-piercing detail

This larger aperture also suits our 'easy-fix' range of 'L' & 'T' handles.

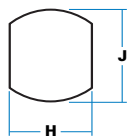

H Piercing across flats	22 mm
J Piercing, diameter	24 mm

SPECIFICATION

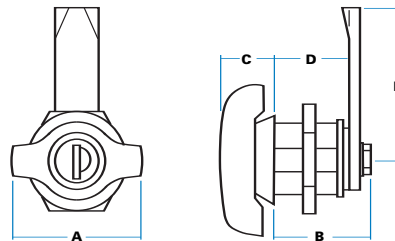

A Face width	45 mm
B Body depth	37 mm
C Face height	14 mm
D Depth to latch	30 mm
E Height of latch	48 mm

Latch bar can be fitted at 90° intervals

Latch-bar options

Straight bar is fitted as standard

5/00276
Cranked 'up'
9.5mm



5/00275
'straight'



5/00097
Cranked 'down'
9.5mm



Straight latch bar is fitted as standard, with two options cranked 9.5 mm 'up' or 'down'. Lock will accept all other bars with 8 mm piercing, including 2/3-point options.

90° LH MOVEMENT

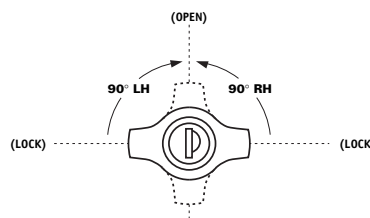

Handles operate LH (clockwise) but lock in horizontal position only. Key does not withdraw in 'open' position.

**'TURNBUTTON'
LOW-PROFILE
LOCK UNIT
('WING' HANDLE)**

The 'turnbutton' lock is fitted with a direct-action operating bar, making it an extremely low-profile handle for securing doors or for driving rod mechanisms.



Rotation is 90° LH. Key operates only when handle is horizontal, but key withdraws in both locked positions.



Insert from front into pierced aperture and fix with large hexagon nut. Neoprene gasket and stainless spring washer are provided.



'FT' keys as standard with 'shuttered' keyway. Optionally 'FS' or 'DLP' key types.



Bright chromium-plated or black powder-coated.



- Cranked latch bars
- 2/3-point bars & rods
- Special key numbers or sets

