



9/00114B











Diecast key has recess for customer logo disc, and can be finished in black or other colours to special order.

9/00729

TOOL-OPERATED COMPRESSION LOCKS

A model intended for use with heavy gaskets and seals, so that when locked the latching bar is drawn up by 6mm and is held firmly in place. Water sealed, fully adjustable, and mounting to industry-standard 4-sided panel aperture. Smart diecast key with provision for customer's identity logo.

-  Very positive engagement against vibration, water-sealed and adjustable.
-  Key operates plug, bringing latch into "closed" position and then drawing up against seal.
-  Latching bar is rotated 90 degrees only, then withdraws by 6mm. Adjustment of latch through 20mm.
-  Through industry-standard 4-sided aperture, secured by brass nut & stainless spring washer on threaded body. Latch bar secured by nut and locknut on end-spigot.
-  7mm-square drive plug
-  Black or chromium-plated.
-  Other drive plugs (triangular, slotted, etc). Alternative latch bars
-  WBH design covered by UK Patent Application 0224237.8

ORDERING CODE

- 9/00114** Compression lock, chrome
- 9/00114B** Compression lock, black
- 9/00729** Diecast key, plain

SPECIFICATION

A Head Diameter	29 mm
B Total Depth (locked)	65.5 mm
C Head projection	8 mm
D1 Depth to latch (min)	36 mm
D2 Depth to latch (max)	56.4 mm
E Body depth	32 mm
F Engagement	47.6 mm
G Body across flats (square)	18.8 mm
H Plug size	7 mm
I "Take-up" Depth	6 mm

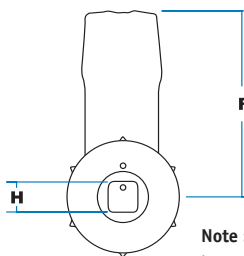
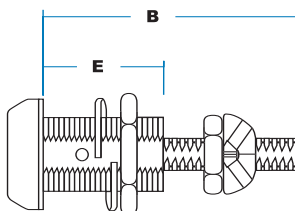
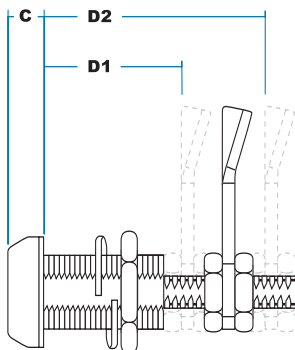
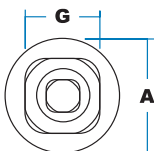

Note : Dots and latch bar to line up when in compressed position

