

9/01956 (set)
Budget latch & catch
plate, complete.



9/01957
(with shaft)

ORDERING CODE

9/01956 Moulded budget latch & striker

9/01957 As above, c/w shaft & pin

SPECIFICATION

A Hole Centres	66 mm
B Case Width	22 mm
C Bolt Projection	19 mm
D Location	33 mm
E Case Length	83 mm
F Thickness	14 mm
H Hole Size (diameter)	Ø 7 mm
J Shaft (when supplied)	10 mm



9/01960

ORDERING CODE

9/01960 Moulded escutcheon cover

SPECIFICATION



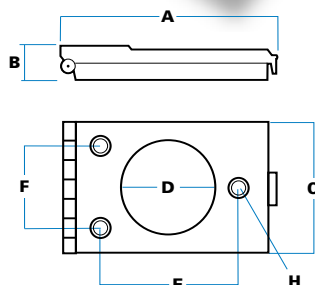

A Length	40 mm
B Height (Max.)	8 mm
C Width	30 mm
D Diameter	16 mm
E Hole Centres	20 mm
F Hole Centres	18 mm
H Hole Sizes, (diameter)	4 mm c/s 6 mm



MOULDED 'BUDGET' LATCH

An ingenious design that replicates the function of our 'Universal' budget latch, but which takes full advantage of the properties of moulded materials. It is tough, lightweight, non-magnetic, self-lubricating, and totally corrosion-resistant.

A special version is supplied with 8mm steel shaft, which can be fitted to either face (9/01957). This is normally used with moulded handle, 5/01664.

-  Simple 'deadbolt' latch, operated by 8mm square or by slot in top & bottom faces, against ramped striker.
-  Non-handed design, with bolt able to travel 180° through case but held positively in open and closed positions by concealed spring.
-  Bolts or rivets through fixing holes in recessed areas. Use large-headed fasteners (to 12mm dia.) for security.
-  Self-colour black with attractive textured finish.
- M** Moulded throughout in acetal copolymer for maximum strength/wear resistance.
- T** Progressive load tests were carried out by an independent proof house, and as a comparison on steel model (3/09656).

Moulded latches operated without distortion until loading of 0.63KN (70Kg). Steel latches became progressively distorted and failed at around 1.5KN (165Kg).

Note These latches are not recommended for applications involving impact loading.

MOULDED ESCUTCHEON COVER

Simple 'snap-shut' covers to protect external panel aperture. Waterproof, opens to 150° for easy fitting (no spring return).