



3/16201 (RH)



HOOKED BUDGET LATCHES

These models have a shaped 'hooked' bolt which engages with a pin to hold two panels together laterally. The shape of the hook and string spring provide very positive engagement.



'Handed' for 90° operation, LH/RH as shown, with deadbolt held positively in both 'open' and 'shut' positions by fitted spring. Note that tip of bolt will project from case when bolt is withdrawn.



Plant-on fixing through 9mm holes. Note that top and bottom plates are mechanically interleaved for maximum strength.



Normal finish is yellow zinc plated.

SPECIFICATION

A Hole Centres	93 mm
B Engagement	24 mm
C Case Width	25 mm
D Location	42 mm
E Case Length	112 mm
F Max. Height	8 mm
G Min. Projection	13 mm
H Hole Sizes	9 mm

Original application: as boot latches, LH on MG Midget, RH on TR4/5.

Right-hand illustrated

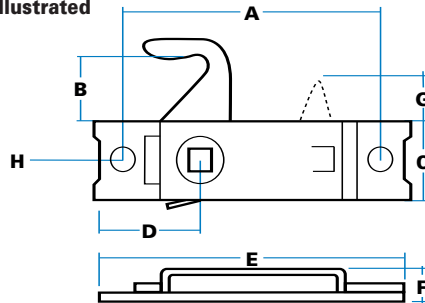

ORDERING CODE

3/16200 Hooked budget latch, LH

3/16201 Hooked budget latch, RH

9/00799

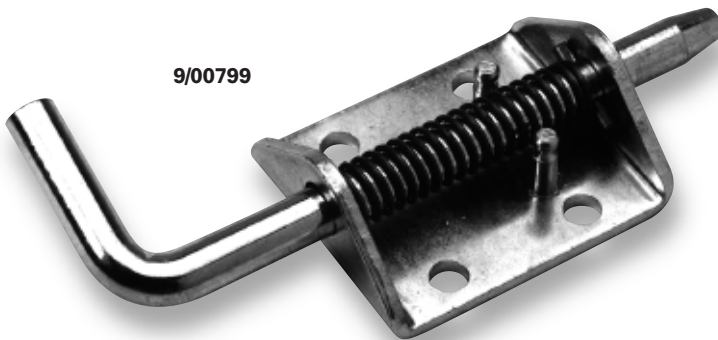

ORDERING CODE

9/00799 Spring bolt

SPECIFICATION

A Case Length	60 mm
B Case Width	50 mm
C Height	15 mm
D Engagement	25 mm
E Projection	10 mm
F Projection	65 mm
G Hole Centres	30 mm
H Hole Sizes (Diameter)	7 mm

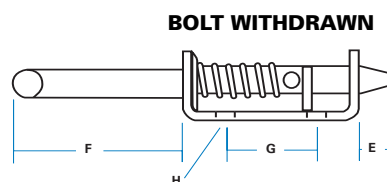
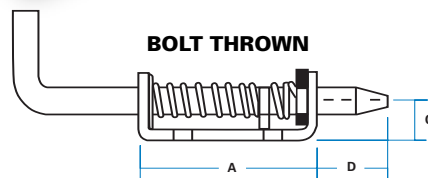

SPRING BOLT (LOCKABLE)

A simple, plate mounted spring bolt, using 10mm diameter steel rod with turned end for easy engagement. When withdrawn the bolt can be turned to lock behind two pillar rivets as shown. Bright zinc-plated finish.